

*American Standard*

# Installation Instructions

## HAMPTON TOP MOUNT KITCHEN FAUCETS

4770.702 SER. 4771.702 SER.  
4770.712 SER. 4771.712 SER.  
4770.722 SER. 4771.722 SER.  
4770.732 SER. 4771.722 SER.  
4771.222 SER.  
4771.322 SER.



*Thank you for selecting American-Standard...the benchmark of fine quality for over 100 years.*

*To ensure that your installation proceeds smoothly—please read these instructions carefully before you begin.*

Certified to comply with ANSI A112.18.1M  
U.S. Patent No. 5,819,789

M968145D

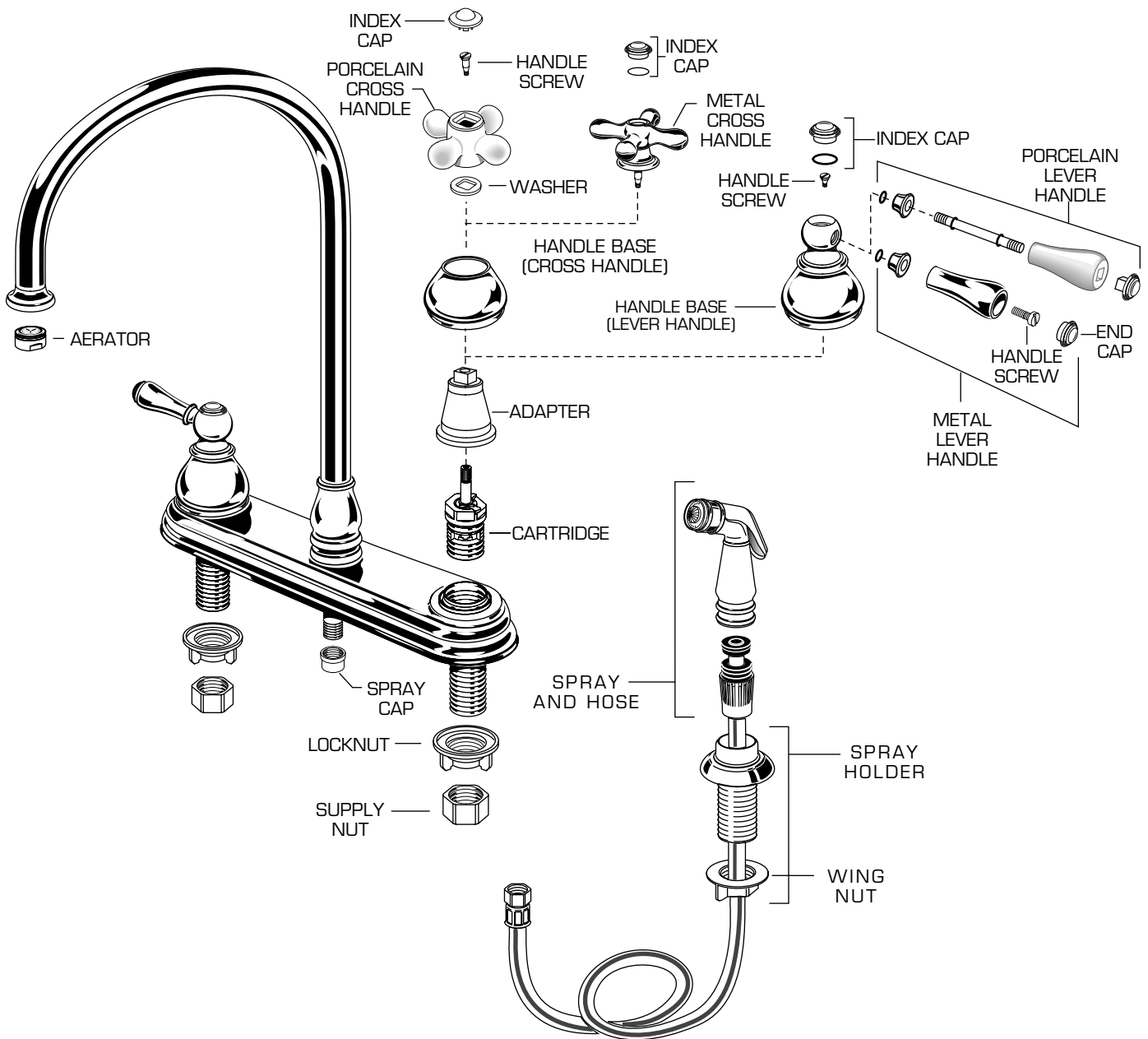

# 1

## INSTALL FAUCET

### CAUTION

Turn off hot and cold water supplies before beginning.

- Screw SPOUT onto BODY.
- Place faucet in position on sink.
- Assemble and tighten LOCKNUTS from underside of SINK.
- Connect the HOT water supply to the left SHANK and the COLD water supply to the right SHANK using sealant, appropriate connectors, and COUPLING NUTS.

To install SPRAY:

- Unscrew SPRAY CAP.
- Place the HOLDER into the appropriate mounting hole. Assemble the SPRAY HOLDER WING NUT onto the shank of SPRAY HOLDER from below and tighten.
- Feed SPRAY HOSE through HOLDER so SPRAY sits in HOLDER.
- From underneath sink, attach COUPLING NUT of SPRAY HOSE to HOSE SHANK. Tighten COUPLING NUT firmly.

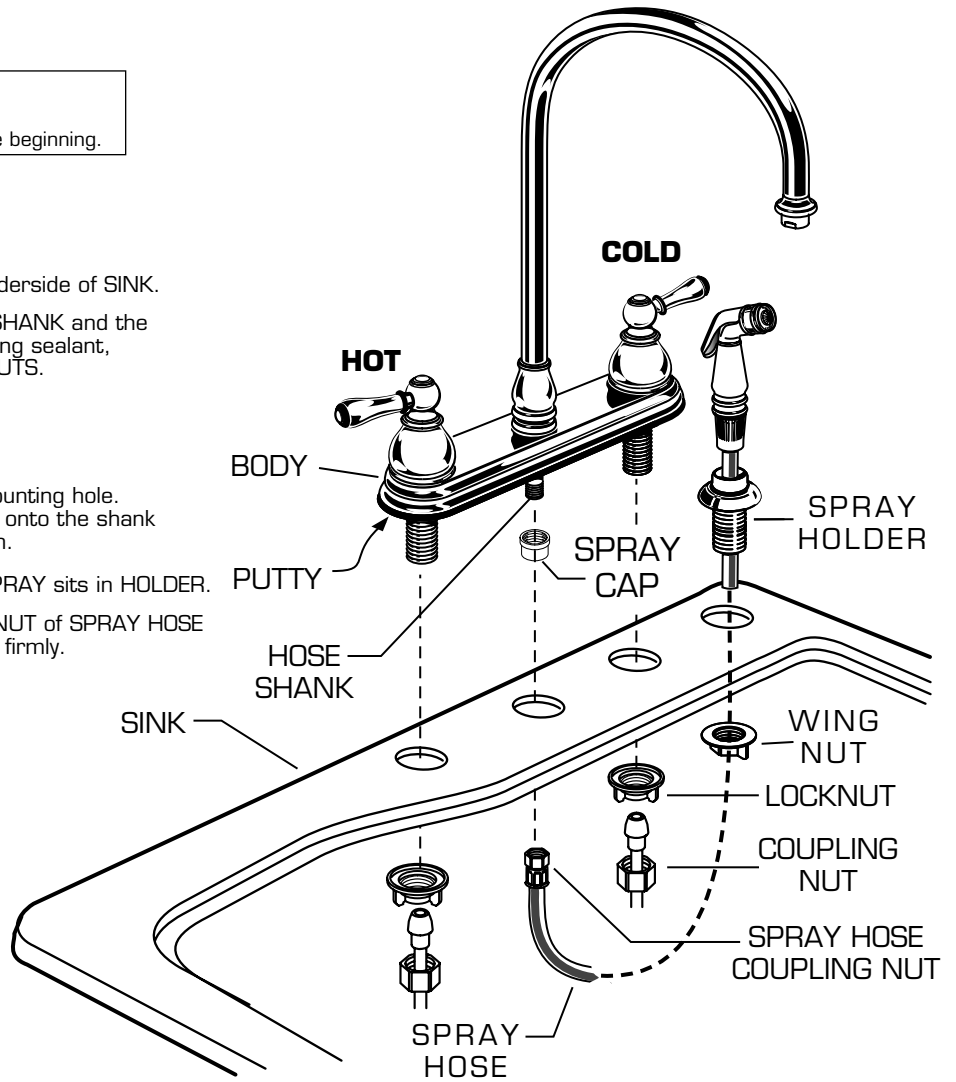

# 2

## TEST INSTALLED FAUCET

- Remove AERATOR.
- With handle in OFF position, turn on water supplies and check all connections for leaks.
- Operate both handles to flush water lines thoroughly.
- Operate SPRAY (if present).
- Turn handles into OFF position and replace AERATOR.

# 3

## SERVICE

- To change direction of handle rotation, proceed as follows:

- Turn valve to OFF position.
- Pull out INDEX CAP and remove HANDLE SCREW.
- Pull off HANDLE BASE and remove ADAPTER.
- Remove SPRING CLIP.
- Lift STOP WASHER, turn 90° and replace.
- Replace SPRING CLIP.
- Reinstall HANDLE.

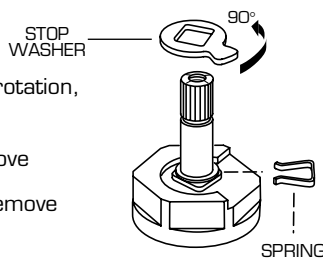

- Handle alignment.
- Check alignment, if not satisfactory aligned;
- Push out ADAPTER carefully.
- Turn ADAPTER either 45° or 90° so that male square on ADAPTER catches different female square in HANDLE BASE.
- Assemble and tighten MOUNTING SCREW.
- Push INDEX CAP in top of HANDLE.

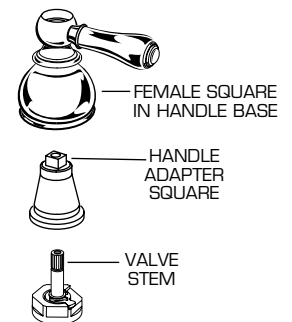

- AERATOR may accumulate dirt causing distorted and reduced water flow. Remove AERATOR and rinse clean.
- If spout drips, operate handles several times from OFF to ON position. Do not force - handles turn only 90°.



HOT LINE FOR HELP  
For toll-free information and answers to your questions, call:  
1 (800) 442-1902  
Weekdays 8:00 a.m. to 8:00 p.m. EST  
IN CANADA 1-800-387-0369 (TORONTO 1-905-306-1093)  
Weekdays 8:00 a.m. to 7:00 p.m. EST