



ENGINEERING EXCELLENCE

Del Mar Series #4DM710T

PARTS BREAKDOWN SHEET

DESCRIPTION

- Two Handle Roman Tub Trim Set
- Metal Lever Handles
- Rigid J Style Spout
- 10" Reach
- 3-Hole 8" to 16" Installation

FINISHES

- PC PVD Polished Chrome
- BN PVD Brushed Nickel
- PN PVD Polished Nickel
- ORB Oil Rubbed Bronze
- TB PVD Tuscany Bronze



#4DM710T SHOWN * ADA

STANDARDS APPLICABLE

- ASME A112.18.1
- ANSI A117.1
- CUPC / IAPMO LISTED / ADA COMPLIANT

Model #: _____

Specific Features: _____

Project Name: _____

Submitted For: _____

Model	Description	Finishes	
#4DM710T	Two Handle Roman Tub Trim Set	<input type="checkbox"/> PC	<input type="checkbox"/> Other____

Required Valve		
#4300B	Two Handle Roman Tub Valve Set	<input type="checkbox"/> N/A



ENGINEERING EXCELLENCE

Pioneer:1-800-338-9468
 Commerce, CA 90040
 www.pioneerind.com
 Pioneer Industries, Inc. © 2013

DMPB4DM710T/REV. 12 2012
 Page 1 of 2

	ITEM#	DESCRIPTION
A	X-1400002*	Del Mar Lever Handle
B	X-4400014*	Del Mar Handle Escutcheon
C	X-4900024	3/32" Allen Wrench
D	X-2400004*	Del Mar 'J' Spout
1	X-4900002	3/32" Allen Screw
2	X-4900026	1/8" Allen Wrench
3	X-4400017*	Spout Hole Cover
4	X-4400018	1/8" Allen Screw
5	X-4400019*	"J" Spout Escutcheon

* Note- Please specify finish/color code while ordering.

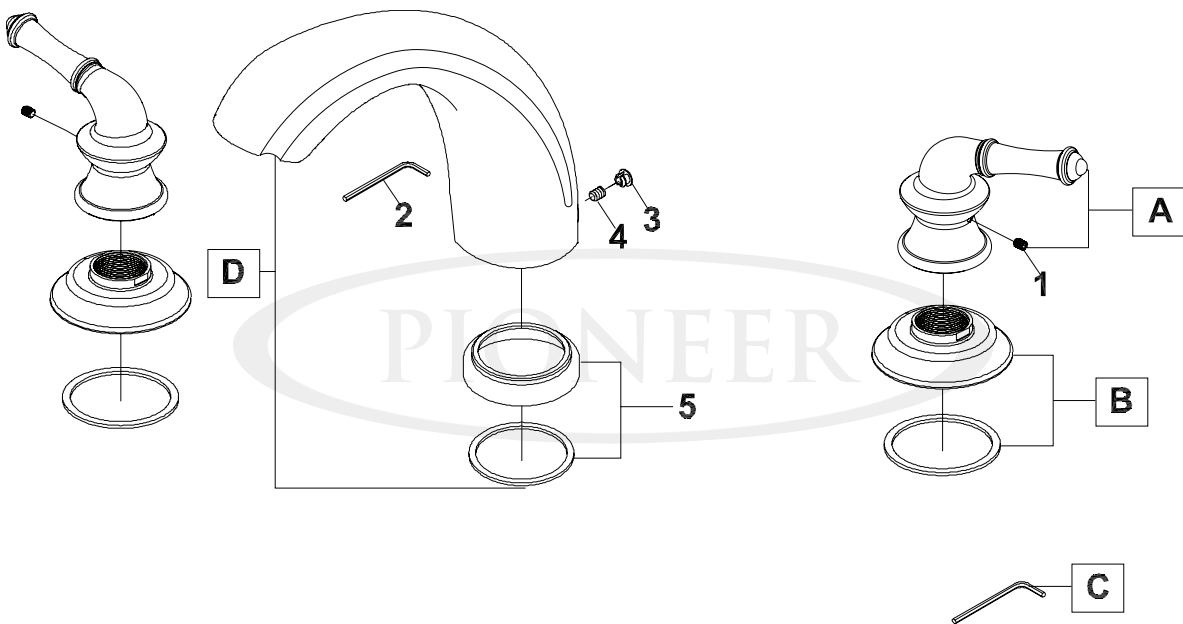

Product Diagram



ENGINEERING EXCELLENCE

Pioneer: 1-800-338-9468
 Commerce, CA 90040
 www.pioneerind.com
 Pioneer Industries, Inc. © 2013