



ENGINEERING EXCELLENCE

Calla Collection #4CL100T

PARTS BREAKDOWN SHEET

DESCRIPTION

- Single Handle Tub and Shower with Diverter Trim Set
- Metal Lever Handles
- Ceramic Disc Cartridge with Temperature Limit Stop
- Five Function 4-1/2" Diameter Showerhead
- 6" Long Shower Arm and Flange
- 1/2" IPS Tub Spout
- Color Match Sleeve and Retaining Ring

FINISHES

- PC PVD Polished Chrome
- BN PVD Brushed Nickel
- SS PVD Stainless Steel
- PN PVD Polished Nickel



#4CL100T SHOWN * ADA 

STANDARDS APPLICABLE

- ASME A112.18.1
- ANSI A117.1
- CUPC / IAPMO LISTED / ADA COMPLIANT

FLOW

- Showerhead Limited to 2.5 GPM

Model #: _____

Specific Features: _____

Project Name: _____

Submitted For: _____

Model	Description	Finishes
#4CL100T	Single Handle Tub and Shower With Diverter Trim Set	<input type="checkbox"/> PC <input type="checkbox"/> Other__
Required Valve		
#4020B-D	Single Handle Tub and Shower and Diverter-Valve Set	<input type="checkbox"/> N/A



ENGINEERING EXCELLENCE

Pioneer: 1-800-338-9468
 Commerce, CA 90040
 www.pioneerind.com
 Pioneer Industries, Inc. © 2013

DMPB4CL100T/REV. 12 2012

Page 1 of 2

	ITEM#	DESCRIPTION
A	X-6400068*	Shower Arm Flange
B	X-4400079	1/2" Nipple
C	X-6400067*	Shower Arm
D	X-6400062*	Five Setting Calla Showerhead
E	X-3400007	Ceramic Disc Cartridge
F	X-4400030*	Sleeve
G	X-4400080	Lock Nut
H	X-4200001*	Retainer Cap
I	X-6400065*	Face Plate
J	X-1400035*	Calla Handle
K	X-6600003*	Diverter Flange
L	X-4600035*	Diverter Valve Sleeve
M	X-1600008*	Diverter Handle
N	X-4900024	3/32" Allen Wrench
O	X-6400066*	Tube Spout
I	X-4900002	Allen Screw

* Note: Please specify finish/color when ordering.

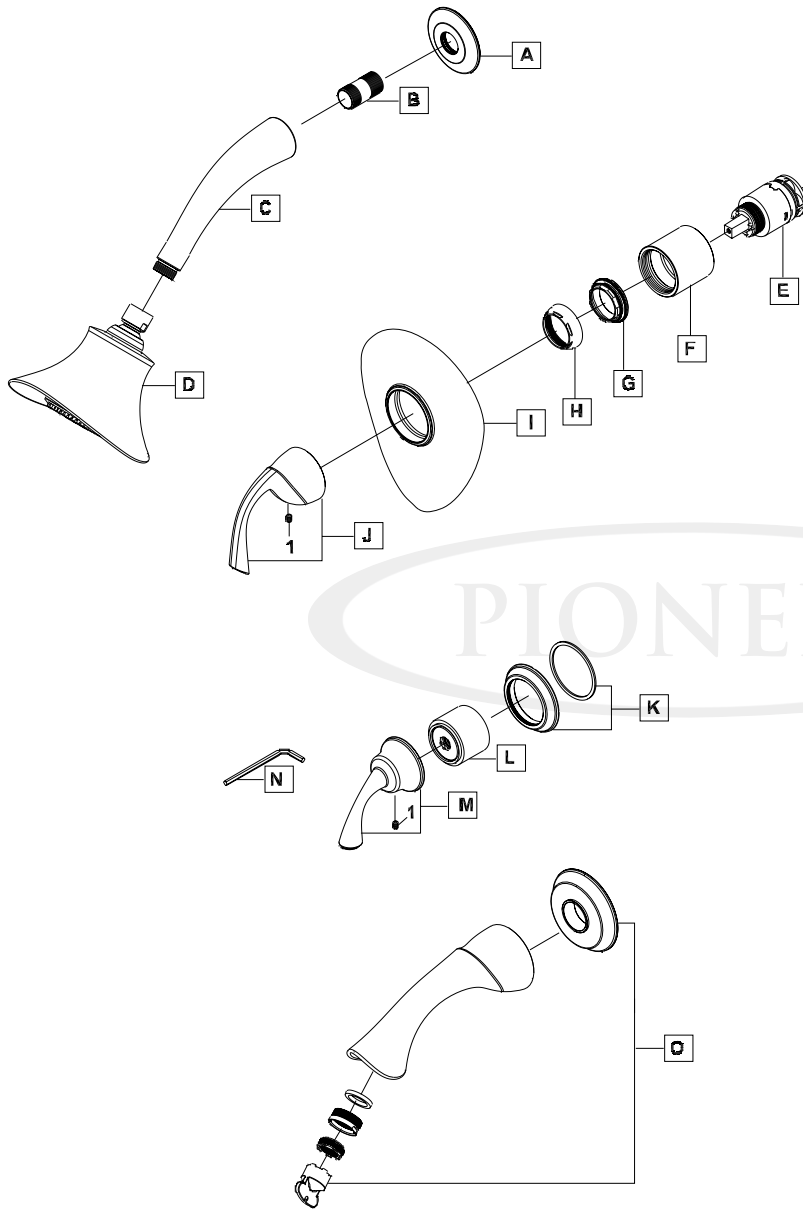

Product Diagram

