

PARTS EXPLOSION

03 Series Two-Handle Tub & Shower

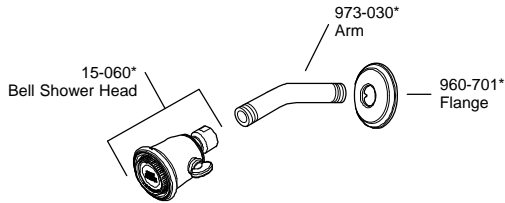

LEVER HANDLE		
940-995*	Solid Brass	
940-996A	Chrome Lever, Pforever Pfinish Polished Brass End	
940-996W	White Lever, Chrome End	
940-994*	Oak Wood	
940-900*	Acrylic	
940-991*	Porcelain, White	
940-992P	Porcelain, Green	
940-993A	Porcelain, Black	
940-905*	Swirl Acrylic	

O-Ring

CAUTION: Be sure to position Valve Body correctly in wall, "SHOWER" marking up and "TUB" marking down.

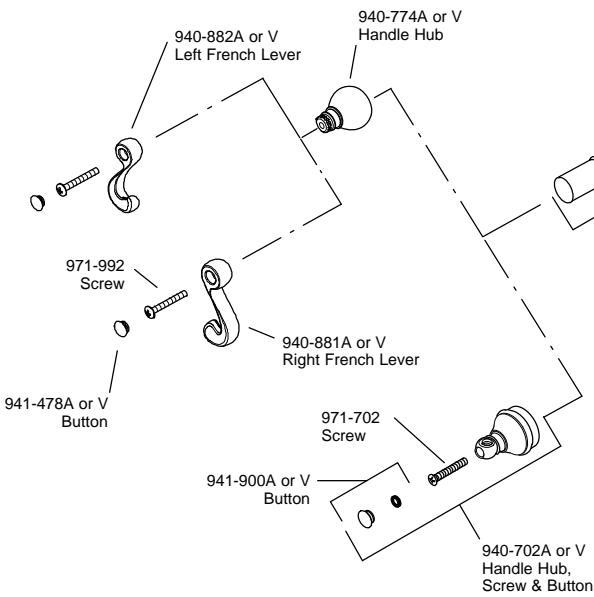
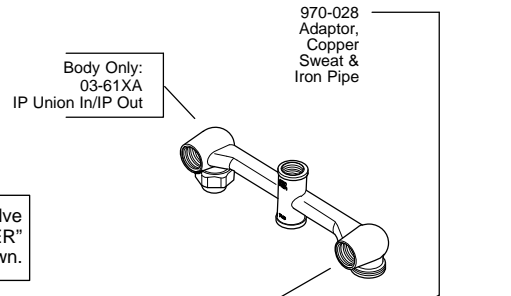

910-007 Stem Extension Kit
1 Per Faucet

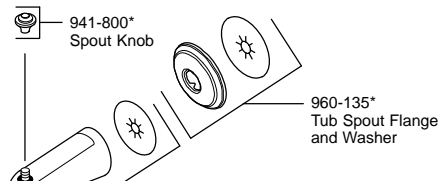

FINISHES * Indicates Finish

A Polished Chrome	M Almond	U Rustic Bronze
B Black	N Antique Bronze	V PVD Polished Brass
E Rustic Pewter	P Polished Brass	W White
D PVD Polished Nickel	Q Satin Brass	Y Tuscan Bronze
J PVD Brushed Nickel	R Copper	Z Oil-Rubbed Bronze
K Satin Nickel	S Stainless Steel	
L Satin Stainless	T Biscuit	

All finishes not available on all parts

1-800-PFAUCET www.pricepfister.com
19701 DaVinci, Lake Forest, CA 92610

07/15/08

Price Pfister