

Standard InSinkErator Mountings

#5 MOUNTING ASSEMBLY

Follow these instructions to install a #5 sink flange to a standard 3-1/2 to 4 inch sink opening.

1. Unscrew the three backup screws (6) until they are flush with the upper mounting flange (5) surface. Pry the retainer ring (7) free from the strainer flange (2) with a screwdriver and separate all mounting assembly parts (2-7).
2. Form a 3/4" thick ring of top grade oil base putty around the sink opening (use a non-hardening putty). Insert the strainer flange (2) into the sink opening and press firmly in place. Clean away any excess putty.
3. From underneath the sink, place the strainer flange gasket (3), back up flange (4) - flat side up, and upper mounting flange (5) over the strainer flange and hold them up to the sink. Snap the retainer ring (7) into the groove on the strainer flange to hold the mounting parts in place.
4. Tighten the three backup screws evenly until the backup flange draws snugly against the underside of the sink and the strainer flange is held securely in place.
5. Place the body flange (9 - lugs upward) over the lip of the mounting flange (10) and fit the mounting gasket (8) onto the lip.
6. Place the mounting gasket (11) on the disposer body flange. Secure the mounting flange (10) to the disposer body flange with six screws (12) provided.
7. Raise the disposer to the upper mounting flange (5) so the body flange (9) is positioned with the lugs to the right of the screws.
8. While supporting the disposer, turn the body flange (9) to the right until all three lugs are engaged in the mounting flange (5). Swivel the disposer to align the discharge outlet with the drain tap. The disposer can be turned 360 degrees.
9. Align the disposer to the plumbing connection and insert the service wrench into the left side of a lug and continue to turn the body flange to the right (approximately one quarter turn) until it locks onto the notches on the upper mounting flange.

NOTE: Special mounting instructions are included in the #5 Short Mounting Kit.

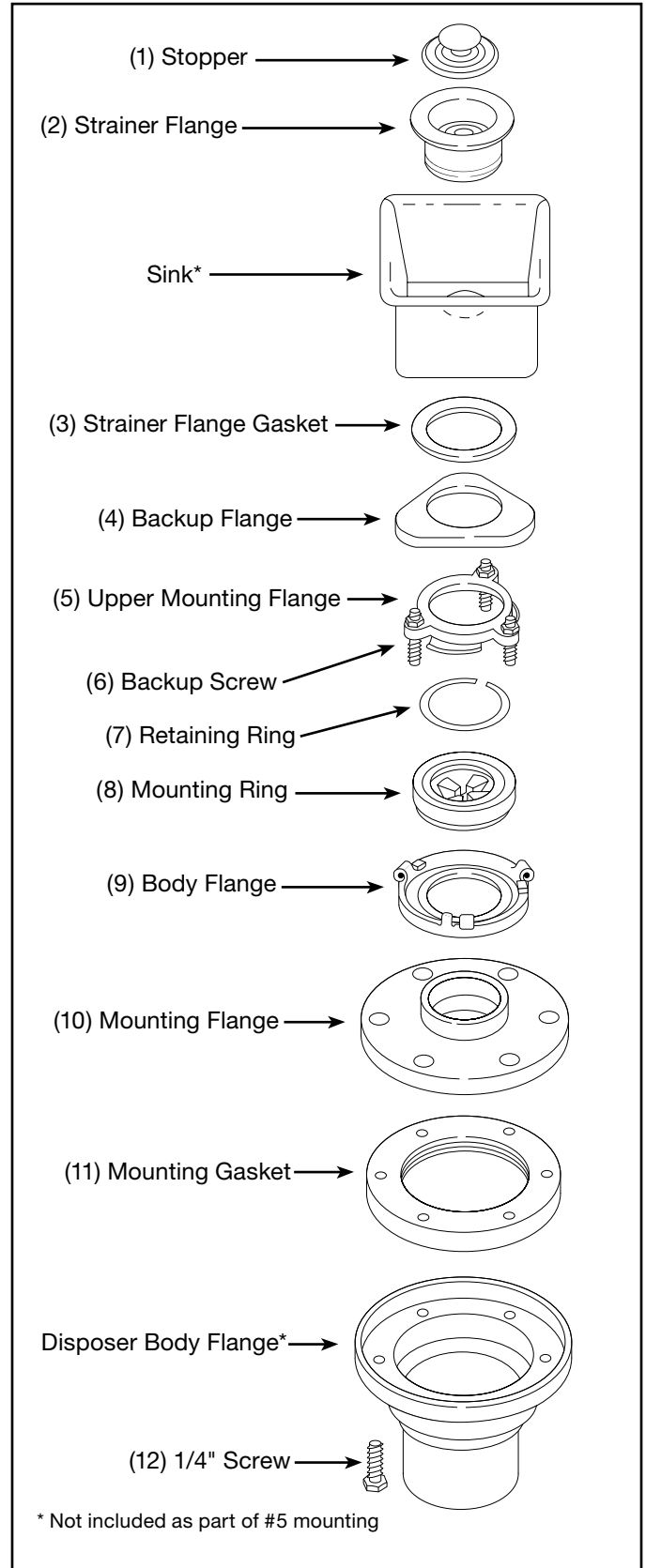

Figure 3. #5 Mounting Assembly