

These are the minimum recommendations for installation. The installer is responsible for complying with all local requirements and project specifications. The installer shall also be responsible to caulk the louver watertight before installation.

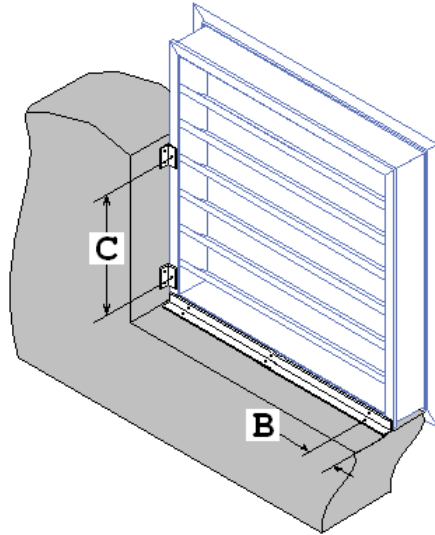

Flanged Frame Louver

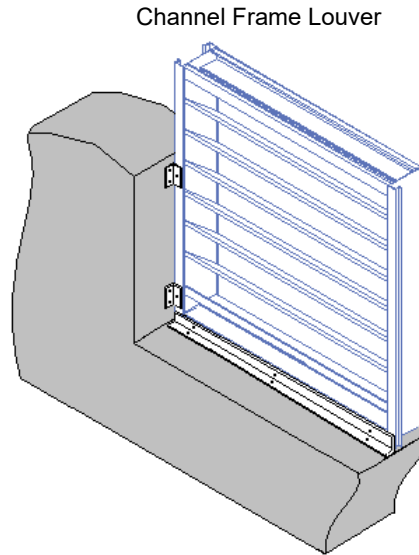

Channel Frame Louver

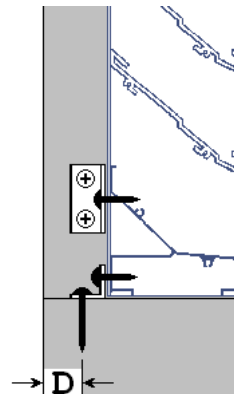
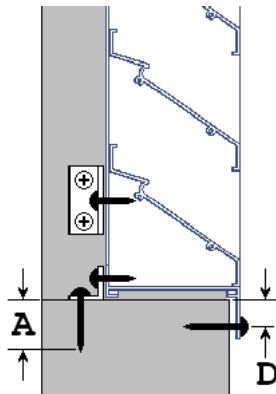

Louver being installed with angles or angle clips should have fasteners located as per the following chart:

| Rough Opening Material | Screw Size | Minimum Fastener Engagement (A) | Maximum Distance from End (B) | Maximum Spacing (C) | Minimum Distance to Opening Edge (D) |
|------------------------|----------------------------|---------------------------------|--------------------------------|--------------------------------|--------------------------------------|
| Concrete | 3/16 – 1/4" Concrete Screw | Note | 1 Times the Louver Frame Depth | 4 Times the Louver Frame Depth | 1 1/8" – 1 1/2" |
| | 1/2" Anchor | Note | | | Note |
| Metal | #10-#14 Tek Screw | Through | | | 1/2" |
| | 1/4" Bolt | Through | | | 3/4" |
| Wood | #10-#14 Screw | 1 1/2" | 3/4" | | |

Note: Per Manufacturers Recommendation

For flanged frames
caulk opening
perimeter before
seating the frame
and after installation.

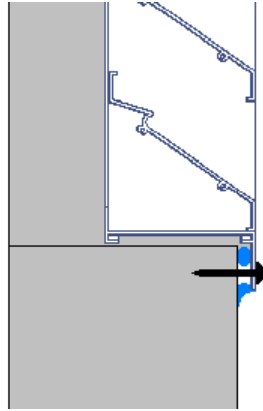

For gaps
over 1/4"
install
backer rod

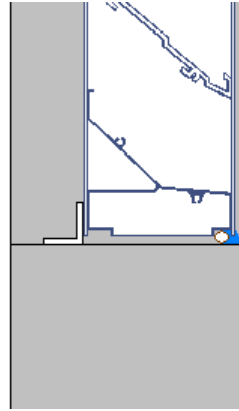

1. The opening should be at least 1/4" larger than the louver in each direction.
2. Install separate flashing or sill pan if required.
3. Shim the louver so it is central in the opening and square and plumb.
4. For flanged frame assembly, caulk the entire perimeter of the opening before seating the flange against the wall.
5. For channel frame assembly, position the louver, per approved architectural drawings, and anchor the angles or angle clips as per the schedule above.
6. Install #10 to #14 sheet metal screws (or TEC screws) into the louver frame/flange starting 1 frame depth from each edge (i.e. 4" from the corner for a 4" louver). (Always use deference to project or architect specified fasteners and fastening requirements).
7. Screws should then be spaced no more than 4 frame depths apart.
8. Usual torque requirements for sheet metals screws is 12-24 inch pounds for #10 screws and 40-52 inch pounds for #14 (1/4") range screws.
9. Caulk the entire perimenter. Use backer rod for gaps over 1/4".