

Strong Arm™ with Plastic Bend Support

Installation Instructions

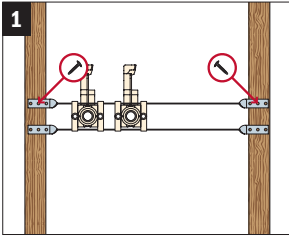

1 Determine stub out height. Secure top bracket to face of stud bay.

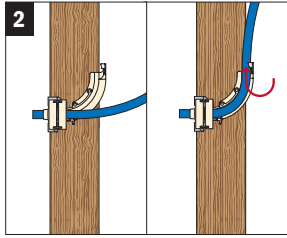

2 Working from the back of the bracket, insert flexible tube through the nose of the front block then bend tube and capture in place at tail end of elbow.

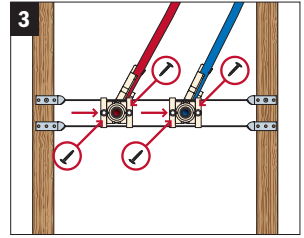

3 Slide plastic elbow block assembly to desired stub out location. Insert two screws into each block and tighten. Tightening screws prevents lateral movement of blocks on brackets and prevents elbow from swiveling.

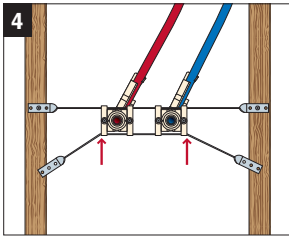

4 As close as possible to each block, bend the bottom bracket downward. Bending the bottom bracket provides the most rigid installation.

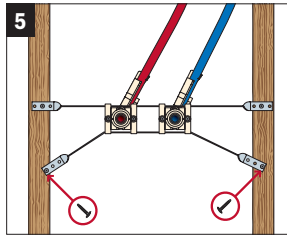

5 Secure each side of bottom bracket to stud.

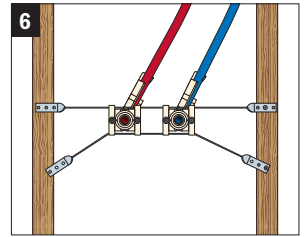

6 Installation complete.

24110 South Peculiar Drive
Peculiar, Missouri 64078

P 1.800.821.3944

F 1.800.758.5950

Patent # 8,061,390
Patent # 8,141,831
#IS-525-PB 11/14

Supply Drainage Support

www.siouxchief.com

TAKE THE FIELD.

