

FLUSHMATE TANKS & REPAIRS

REPLACEMENT TANKS



501B SERIES



503 SERIES

COMPLETE UNITS

CAT NO:	OEM	
381 X 503	M101526 - FA	#501B For American Standard
381 X 504	M101526 - F	#501B For All Other Manufacturers
381 X 505	M101526 - F31	#503 For all oems except below
381 X 506	M101526 - F32	#503 For Kohler 4404 tank
381 X 507	M101526 - F33	#503 For all 10" rough ins

200 SERIES REPAIR PARTS



CAT NO.	OEM	DESCRIPTION
921 F 105	C100101K	Cartridge ONLY for 200 series
921 F 104	RK100100	Upper & lower supply kit ONLY

500 SERIES REPAIR PARTS

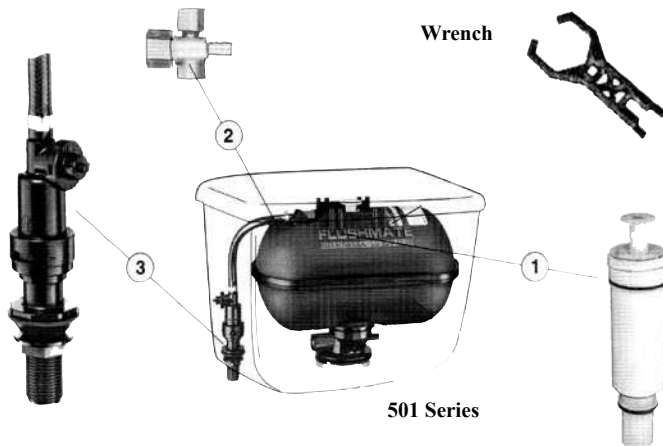

#	CAT NO.	OEM	DESCRIPTION
1	921 F 103	C100500	Cartridge for all 500 series
2	921 F 107	BU100505K	Upper Supply for all 500 series
-	921 F 102	BU100503K	Upper Supply (only for model 102540-- (not shown))
3	921 F 104	RK100100	Upper & Lower Supply kit for all series (except 503)
4	921 F 106	BL100504-3K	Lower Supply for 503 series only
5	921 F 101	BL100504-K	Lower Supply for 501 series only
6	921 F 100	ST100100	Wrench for all series

The 503 Series does not use an upper supply unit.

SLOAN INTELLIFLUSH SYSTEM

Change A Traditional Flushmate To An Automatic Flushing Flushmate!

Exclusive Electronic Retrofit Kit for Sloan FLUSHMATE®,

INTELLI-Flush™ Automatic Flushing System

- Proven Infrared Object Lock Technology controls flushing like no other system
- Ideal for new 1.0 gallon or 1.6 gallon FLUSHMATE systems or updating previous models*
- Field-tested design
- Remote sensor includes Battery and User Indicator and adjustable sensor range
- Green LED flashes when user is detected
- Yellow LED flashes for low battery
- Easy to install on-wall or in-wall sensor system
- Optional in-wall sensor for tamper-resistant installation
- Sealed battery compartment
- Factory preset for optimum operation
- Easy to follow instructions included
- Retrofits to FLUSHMATE 501-B, 503, and 504
- Sensor trim available in chrome or white
- On-wall or In-wall sensor - • 3 year warranty - • 3 year battery life

Easy to install on-wall or in-wall sensor system



INTELLI-Flush™
Automatic Flushing System
On-Wall Sensor,
with white trim

CAT NO.	OEM
921F200	K-100100



INTELLI-Flush™
Automatic Flushing system
In-Wall Sensor,
with white trim

CAT NO.	OEM
921F202	K-100102



INTELLI-Flush™
Automatic Flushing System
On-Wall Sensor,
with chrome trim

CAT NO.	OEM
921F201	K-100101

INTELLI-Flush™
Automatic Flushing System
In-Wall Sensor,
with chrome trim

CAT NO.	OEM
921F203	K-100103

Automatic Flushing
System with
override button,
NO SENSOR



CAT NO.	OEM
921F204	K-100500

FLUSHMATE TANKS & REPAIRS

AMERICAN STANDARD FLUSHMATE HANDLES

For Old Style Yorkville (4086)

CAT NO.	OEM	DESCRIPTION
322C053	738253	RH Tank Lever AND linkage
322C054	738254	LH Tank Lever AND linkage

CAT NO.	OEM	DESCRIPTION
322C055	738154	RH Tank Lever Only
322C056	738153	LH Tank Lever Only

CAT NO.	OEM	DESCRIPTION
N/A	N/A	RH Internal Linkage ONLY
N/A	N/A	LH Internal Linkage ONLY



For Yorkville / Cadet / Glenwall (4098)

CAT NO.	OEM	DESCRIPTION
322C065	738494	RH Tank Lever only
322C066	738473	LH Tank Lever only

322C067	738495	RH Internal Linkage only
322C068	738493	LH Internal Linkage only

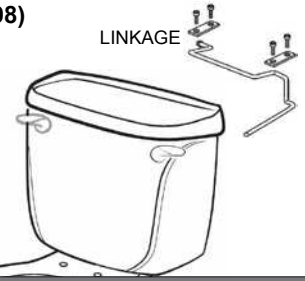

AMER. STANDARD FLUSH BUTTONS

- Chrome Plated Push Button for Tank Lid
- Available Convex (Domed--as shown) or Concave (Indented)



CAT NO.	DESCRIPTION
322 C 052	Chrome - Convex Button Assy.
322 C 051	Chrome - Concave Button Assy.

KOHLER TANK LEVERS & LINKAGES

- Used on K-3493, K-3505, K-3519, others.

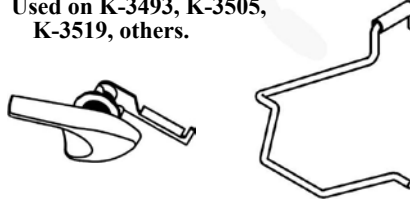

CAT NO.	OEM #:	DESCRIPTION:
322 C 046	1044434	LH Tank Lever (shown)
322 C 047	1045276	LH Actuator Arm (shown)
322 C 048	1044435	RH Tank Lever
322 C 049	1045277	RH Actuator Arm

- Used on K-3546, K4413, K-9436, others.

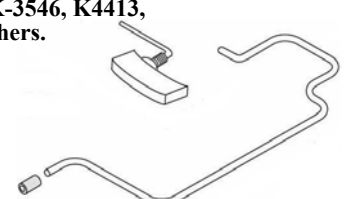

CAT NO.	OEM #:	DESCRIPTION:
322 C 090	84875	RH Tank Lever (shown)
322 C 091	84874	LH Tank Lever

(Actuator arms have been revised by Kohler over the years. Call with tank # for exact replacement.)

CRANE ECONOFLUSH TANK LEVERS AND ARMS

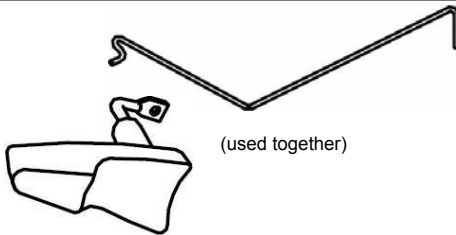

CAT NO.	OEM #:	DESCRIPTION:
322 C 088	P030330	LH Tank Lever
322 C 097	P030180	Actuator Arm

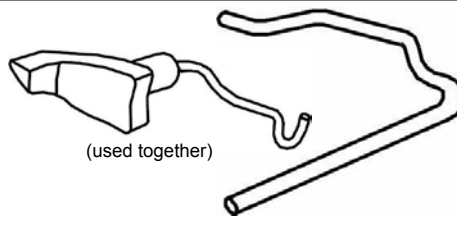

CAT NO.	OEM #:	DESCRIPTION:
322 C 089	P030389	LH Tank Lever
322 C 095	P030178	Actuator Arm

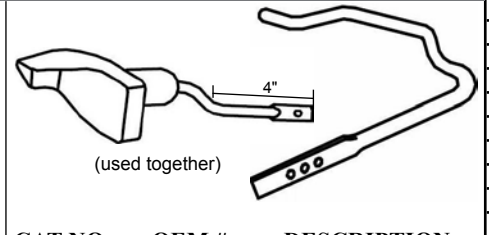

CAT NO.	OEM #:	DESCRIPTION:
322 C 087	P030384	LH Tank Lever
322 C 096	P030388	LH Actuator Arm
322 C 086	P030383	RH Tank Lever

GEBERIT / WC TECHNOLOGY PF/2 SYSTEM

In 2002, The Geberit Group acquired 100% of the shares of W/C Technology Corporation (WCTC) from Masco Corporation. WCTC manufactured the "camel hump" version of the power assist toilet, used by Eljer, Gerber, & Geberit. Here are the available parts. **(THIS SYSTEM IS ALSO KNOWN AS THE PF/2 SYSTEM)**

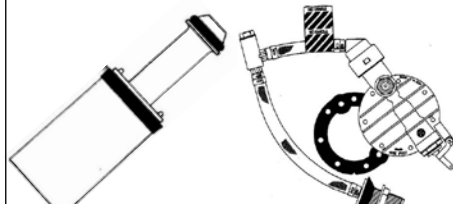
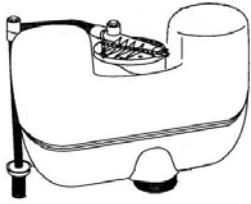

Inlet Assy and Cartridge

CAT NO.	DESCRIPTION	DISCONTINUED
WC140	Rebuild Kit (for model 140 - For 1 piece toilets)	
WC150	Rebuild Kit (for model 150 - For 2 piece toilets)	



WC352 (for model 140) cartridge & gasket
WC350 (for model 150) cartridge & gasket



WC359 gasket & screws



WC361 chain & hooks



WC302AC actuator valve



WC289 linkage arm

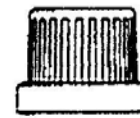

WC330K shank filter



WC353 air inducer

FLUSHMATE TANKS & REPAIRS

FLUSHMATE TANK CHEATER CHART

OEM	Tank #	Flushmate Series	LH Trip Lever	RH Trip Lever or Actuator Rod	Tank to Bowl Gasket
American Standard (look under lid for ID #)	4086 (Old Yorkville)	501-A, 501-B	322C054 (738254-0070A) Includes LH Lever and Arm 322C056 (738153-0070A) LH Tank Lever Only	322C053 (738253-0070A) Includes RH Lever and Arm 322C055 (738154-0070A) RHTank Lever Only	177R015 (47218)
	4098 (New Yorkville/ Glenwall/Cadet)	503	322C066 (738473-0070A) LH Tank Lever Only 322C068 (738493-0070A) LH Linkage Only	322C065 (738494-0070A) RH Tank Lever Only 322C067 (738495-0070A) RH Linkage Only	177R015 (47218)
Crane	Economiser 3617 ('94-'99) (see picture on page 4-35) Economiser 3612 ('03-present, with PF/2 tank) Economiser 3612 ('01-'03) Economiser 3612 ('99-'01)		322C087 (P030384 LH Lever) 322C088 (P030330 LH Lever) 322C089 (P030389 LH Lever) 322C087 (P030384 LH Lever) 322C086 (P030383 RH Lever)	322C086 (P030383 RH Lever) 322C096 (P030388 actuator rod only) 322C097 (P030180 actuator rod only) 322C095 (P030178 actuator rod only)	(see picture on page 4-35) (see picture on page 4-35)
Eljer			322C110 (495-1965 LH Lever) <i>(Some Eljer tanks use the Geberit PF/2 system. See page 4-35)</i>	322C096 (P030388 actuator rod only) 322C111 (495-1966 LH Lever)	(see picture on page 4-35)
Gerber	28-390 "UltraFlush" 10" Deep Tank	501-A, 503	322C082 (99-564 FM I) 322C080 (99-571-KT)	322C083 (99-564 RHFMI) 322C081 (99-571-RHKT)	177R015 (99-584) 177R021 (99-538 (Kit*))
	28-380 "UltraFlush" 8" Deep Tank	503	322C080 (99-571-KT)	322C081 (99-571-RHKT)	177R015 (99-584) 177R021 (99-538) (Kit*)
	21-012 "Maurice" One-piece	503 Geberit	322C084 (99-171-KT) 322C085 (99-172)		*kit includes gasket, bolt caps, and ballcock supply nuts. 177R015 (84460)
Kohler (look in tank for ID #)	4413	501-A, 501-B	322C091 (84874) (lever) 322C093 (1007966) (Arm)	322C090 (84875) (lever) 322C094 (1007967) (Arm)	177R015 (84460)
Universal	4463	<i>(other Kohler tank levers and actuator arms are shown on page 4-35)</i> 501-A, 501-B		322C044 (P312-C LH Lever) 322C045 (P313-C Flush Lever)	NLA (P 4-21-A)

FLUSHMATE MODEL IDENTIFICATION - BY SERIES



Series	Serial #	Model #	Style	Description	Replacement Model #*
200	C-XXXXXX	M-101525	2 pc.	Plastic tank enclosure. Push button attached to cartridge.	MA101525-F
500	C-XXXXXX	M-101526	2 pc.	Two hoses attached to Upper Supply. Push button attached. to tank cover lid	M-101526-F (381X504)
		M-101525	2 pc.	Two hoses attached to Upper Supply. Push button attached. to tank cover lid	M-101526FA** (381X503)
		M-102540	1 pc.	Incorporates a bolt plate to attach FLUSHMATE to china.	M-102540-F
501	C-XXXXXX MMDDYY-111-__	M-101526	2 pc.	Stainless steel endbells. One hose attached to Upper Supply.	M-101526-F (381X504)
		M-101525	2 pc.	Stainless steel endbells. One hose attached to Upper Supply.	M-101526FA** (381X503)
		M-102540	1 pc.	Incorporates a bolt plate to attach FLUSHMATE to china.	M-102540-F
501-A	MMDDYY-A01-__	M-101526	2 pc.	Black Upper Supply and one piece design. M-101526-F	M-102540-F
		M-102540	1 pc.	Incorporates a bolt plate to attach FLUSHMATE to china.	M-102540-F
501-B	MMDDYY-F01-__	M-101526-F	2 pc.	Tank is all plastic eliminating the stainless steel end bells.	M-101526-F (381X504)
		M-102540-F	1 pc.	Incorporates a bolt plate to attach FLUSHMATE to china.	M-102540-F
503	MMDDYY-F3_***-__	M-101526-F3	2 pc.	FLUSHMATE tank configured in a rectangular shape and lower supply is in a right angle from inlet to outlet.	M-101526-F3 __ <i>(see page 4-34)</i>
		M-102540-F3	1 pc.	Lower supply is either straight or right angle depending on toilet manufacturer. Incorporates bolt plate to attach FLUSHMATE to china.	M-102540-F3 __ <i>(see page 4-34)</i>
		M-101526-F4	2 pc.	FLUSHMATE tank configured in a rectangular shape and lower supply is in a straight or right angle from inlet to outlet.	M-101526-F4 __
		M-102540-F4	1 pc.	Lower supply is either straight or right angle depending on toilet manufacturer. Incorporates bolt plate to attach FLUSHMATE to china.	M-102540-F4 __

(Parts shown in parentheses are stocked in our warehouses. Other part numbers are available by special order.)

* *When ordering a replacement model, please include the name of the toilet manufacturer.*

One piece units are for American Standard and Gerber only.

Series 503 and 504 units are not a suitable replacement unit for any other series.

** *Fits American Standard models only.*