

# CLIP. TRIM. SAW. HACK.

---

HAND PRUNERS  
HEDGE SHEARS  
LOPPERS  
PRUNING SAWS  
MACHETES  
TREE PRUNERS



# MAX HAND PRUNERS

## How to Pick the Right Size Pruner for Your Hand



**SMALL HANDS**  
Wide: less than 3 1/4 inch  
Height: less than 6 1/4 inch



**MEDIUM HANDS**  
Wide: 3 1/2 to 4 inch  
Height: 6 1/2 to 8 inch

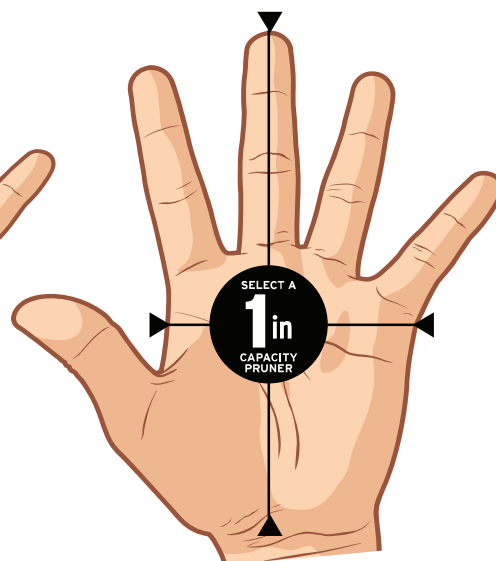

**LARGE HANDS**  
Wide: more than 4 inch  
Height: more than 8 inch

# MAXFORGED

STRENGTH & DURABILITY™

**Forged tough. Proven performance. Season after season.**

Experience the performance and durability of **MAXFORGED** tools with classic, simple designs that withstand the test of time. Agricultural and Landscaping Professionals' tool family of choice.



### MAXFORGED | BYPASS PRUNERS

#### DualCUT

##### BP 7100D

- The **PrecisionZONE** area of hook & blade is for quick, repetitive cuts on stems and smaller branches
- The **PowerZONE** area of hook & blade is for maximum-leverage cuts on branches up to 1 in
- Maximum strength forged technology
- No blade crossover with fully forged steel construction for strength
- Limited Lifetime Warranty
- **REPLACEMENT PARTS AVAILABLE**

Patents U.S. D660,104, 8,910,386  
Canada 2,775,512

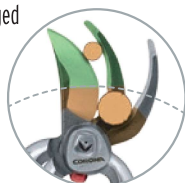

### MAXFORGED | BYPASS PRUNERS

#### ProCUT

##### BP 7200

- Replaceable, resharpenable Dual Arc™ blade
- Advanced blade technology and high-performance blade coating reduce cutting effort by 25% when compared to titanium-coated or non-coated blades
- Comfortable handle with contoured soft grip
- Limited Lifetime Warranty
- **REPLACEMENT PARTS AVAILABLE**

U.S. Patents D660,104





## MAXFORGED | BYPASS PRUNERS

**NEW**

### ClassicCUT®

CUTS UP TO  
1 in

#### BP15180

- Resharpenable, replaceable high-carbon steel blades
- High-precision pivot bolt and locking nut keep blade and hook aligned
- Fully forged steel construction for maximum strength
- Comfortable handle with contoured non slip grips fit various hand sizes
- One handed lock operation
- Limited Lifetime Warranty
- **REPLACEMENT PARTS AVAILABLE**



## MAXFORGED | BYPASS PRUNERS

### ErgoACTION

CUTS UP TO  
1 in

#### BP 3670

- Built-in sprinkler adjuster fits common nozzles
- Resharpenable, replaceable bypass blade
- Maximum strength forged technology
- Ergonomic handles for added comfort
- Limited Lifetime Warranty
- **REPLACEMENT PARTS AVAILABLE**
  - 3670-1C - Replacement blade
  - 3670-91C - Hardware kit - Pivot bolt and nut, spring, lock with screw and washer



U.S. Patent D652,272



## MAXFORGED | BYPASS PRUNERS

### ClassicCUT®

CUTS UP TO  
1 in

#### BP 3180D

- Resharpenable, replaceable high-carbon steel blades
- High-precision pivot bolt and locking nut keep blade and hook aligned
- Fully forged steel construction for maximum strength
- Non-slip grips for greater control
- Limited Lifetime Warranty
- **REPLACEMENT PARTS AVAILABLE**



## MAXFORGED | BYPASS PRUNERS

### ErgoACTION

CUTS UP TO  
3/4 in

#### BP 3640

- Resharpenable bypass blade
- Maximum strength forged technology
- Ergonomic handles for added comfort
- Limited Lifetime Warranty

U.S. Patent D585,251



## MAXFORGED | BYPASS PRUNERS

### ClassicCUT®

#### BP 3160 | CUTS UP TO 3/4 IN

#### BP 3130 | CUTS UP TO 1/2 IN

- Resharpenable high-carbon steel blades
- High-precision pivot bolts and locking nuts keep blades and hooks aligned
- Fully forged steel construction for maximum strength
- Non-slip grips for greater control
- Limited Lifetime Warranty
- **REPLACEMENT PARTS AVAILABLE**



## MAXFORGED | PRUNER + LOPPER

### Convertible

CUTS UP TO  
1 1/4 in

#### BP 7450

- Ease of a pruner with power of a lopper - all in one tool
- Easily converts for two-handed operation
- No blade crossover with fully forged steel construction for strength
- Right- or left-hand activation with center lock
- Comfortable handle with contoured grip
- Limited Lifetime Warranty

U.S. Patent D698,618



## MAXFORGED | TWO-HANDED PRUNER

### ClassicCUT®

CUTS UP TO  
3/4 in

#### BP 3225D

- Lightweight, two-handed operation for easier cutting
- Forged, resharpenable bypass blade and hook
- Oval aluminum handles for greater comfort
- Handle length - 11 1/4 in
- Limited Lifetime Warranty



# MAX HAND PRUNERS

STRENGTH & DURABILITY



## MAXFORGED ALUMINUM Bypass Pruners

- Lightweight forged aluminum handles with non-slip grips
- High-carbon steel blades for lasting performance
- Easy access to tight areas with narrow profile hooks
- Geared pivot nuts permit precise blade adjustments
- Built-in wire cutters and sap grooves
- Volute springs resist clogging and maintain smooth cutting action
- Rubber bumpers absorb shocks
- Limited Lifetime Warranty
- **REPLACEMENT PARTS AVAILABLE**



### MAXFORGED | BYPASS PRUNERS ALUMINUM

CUTS UP TO  
**1 in**

#### BP 6250

- Straight, non-angled head
- Blade and spring are interchangeable with Felco® 2\*



### MAXFORGED | BYPASS PRUNERS ALUMINUM

CUTS UP TO  
**3/4 in**

#### BP 6310

- Compact, great for smaller hands
- Ergonomically angled head for less bending of the wrist
- Blade and spring are interchangeable with Felco® 6\*



### MAXFORGED | BYPASS PRUNERS ALUMINUM

CUTS UP TO  
**1 in**

#### BP 4250

- More affordable, heavier version of BP 6250
- Separate steel hook instead of one-piece aluminum hook
- Blade and spring fit Felco® 11\*



### MAXFORGED | BYPASS PRUNERS ALUMINUM

CUTS UP TO  
**1 in**

#### BP 6340

- For left handed users
- Ergonomically angled head for less bending of the wrist
- Blade and spring are interchangeable with Felco® 9\*



### MAXFORGED | BYPASS PRUNERS ALUMINUM

CUTS UP TO  
**1 in**

#### BP 4840

- Unique rolling handle designed to reduce cutting effort and hand fatigue
- Blade interchangeable with Felco® 7\*



### MAXFORGED | BYPASS PRUNERS ALUMINUM

CUTS UP TO  
**1 in**

#### BP 6360

- Ergonomically angled head for less bending of the wrist
- Blade and spring are interchangeable with Felco® 8\*

\*Felco® is a registered trademark of Felco SA, Switzerland

# HAND PRUNERS



## BYPASS PRUNER

### FlexDIAL™

with **ComfortGEL®** grip  
BP 4214D

- Adjustable grip fits to hand size and reduces fatigue during repetitive cuts
- Anodized aluminum dial ranges from 1 for smaller hands to 8 for large hands
- Maximize comfort and control with soft, ergonomically shaped grips
- Specially coated non-stick blades provide smooth cutting performance
- Limited Warranty



Patents: U.S. D802,382, Canada 172123, 10,022,881



## BYPASS PRUNER

### DualLINK™

with **ComfortGEL®** grip  
BP 4314D

- Dual compound lever provides added power with reducing cutting effort
- Specially coated non-stick blades provide smooth cutting performance
- Limited Warranty

Patents: U.S. D802,381, Canada 172122



## RATCHET PRUNER

### RatchetCUT™

with **ComfortGEL®** grip  
RP 4224D

- Ratchet action for easier, more comfortable multi-cuts through tough, thick branches
- 4-gear ratchet system
- Maximize comfort and control with soft, ergonomically shaped grips
- Specially coated non-stick blades provide smooth cutting performance
- Limited Warranty

Patents: U.S. D802,383, Canada 172120



## ComfortGEL® Hand Pruners

- Maximize comfort and control with soft, ergonomically shaped grips
- Specially coated non-stick blades provide smooth cutting performance
- Reduce hand fatigue with ShockGUARD® bumper system on some models



## BYPASS PRUNER

### NEW ComfortGEL®

BP 3324

- Bypass design for pruning live green growth and fruits and veggie vines
- Suitable for right- and left-hand use
- Build in thorn stripper for stems up to 3/8 in diameter
- Full Steel construction
- Limited Warranty



## BYPASS PRUNER

### ComfortGEL®

BP 3214D

- Bypass design for pruning live, green growth
- Suitable for right- and left-hand use
- Reduced hand fatigue with ShockGUARD® bumper system
- Limited Warranty



## ANVIL PRUNER

### NEW ComfortGEL®

AP 3334

- For pruning dead and dry woody growth.
- Brand & stem pruner with ComfortGEL® grips for superior comfort and less hand fatigue
- Non-stick blade
- Reduce hand fatigue with Shock Guard® bumper system
- Limited Warranty



**WARNING:** This product can expose you to chemicals including phthalates (BBP, DBP, DEHP, DIDP, DINP and DNHP) and lead which are known to the State of California to cause cancer, birth defects or other reproductive harm. For more information go to [www.P65Warnings.ca.gov](http://www.P65Warnings.ca.gov)

# HAND PRUNERS



## BYPASS PRUNER

**BP 3140 | CUTS UP TO  $\frac{5}{8}$  IN**

- Bypass design for pruning live, green growth
- Steel body with non-stick coated steel blade
- Enclosed spring is protected from debris
- Lightweight, well-balanced design for extended use
- Textured grips for non-slip cutting comfort
- Limited Warranty



## ANVIL PRUNER

**AP 3110 | CUTS UP TO  $\frac{3}{4}$  IN**

- Anvil design for pruning dry and woody growth
- Steel body with non-stick coated steel blade
- Enclosed spring is protected from debris
- Lightweight, well-balanced design for extended use
- Textured grips for non-slip cutting comfort
- Limited Warranty



## RATCHET PRUNER

**RP 3230 | CUTS UP TO  $\frac{3}{4}$  IN**

- Power-multiplying ratchet action for easy cutting
- Non-stick coated blade for smooth cutting and easy cleaning
- Suitable for right- and left-hand use
- Limited Warranty



## SMALL/MEDIUM HAND PRUNER

**ComfortGEL®**

**BP 3224**

- Ideal for cutting fruit and veggie vines such as tomatoes, cucumbers and more
- Suitable for right- and left-hand use
- Built-in thorn stripper for stems up to  $\frac{3}{8}$  in diameter
- Limited Warranty

CUTS UP TO  $\frac{1}{2}$  IN



## ERGONOMIC BYPASS PRUNER

**BP 4180 | CUTS UP TO  $\frac{3}{4}$  IN**

- Lightweight pruner for general-purpose pruning
- Ergonomic, reinforced nylon handles
- Resharpenable, high-carbon steel blade
- Limited Warranty
- **REPLACEMENT PARTS AVAILABLE**



## BYPASS PRUNER

**Cut'n'HOLD LongREACH**

**LR 3460**

- High-carbon steel blade and hook are fully heat-treated
- Overall length of 46 in allows reach to otherwise inaccessible areas
- Non-stick coated blade for easier cutting
- Adjustable foam grip provides balance and ease of use
- Cut 'n' hold feature holds stem until you release the grip
- Ergonomic grip for comfort
- Limited Warranty

CUTS UP TO  $\frac{1}{2}$  IN



## LONG REACH PRUNER

**SwivelCUT**

with **PowerGLIDE™** grip

**TP 3206 | REACHES UP TO 62 IN**

- Head rotates 360°, tilts and swivels for unlimited cutting positions
- Overall length of 62 in is ideal for pruning high or low, without bending or straining
- Lightweight: weighs only 2.5 lb so you can prune trees, shrubs and roses all day
- PowerGLIDE™ comfort grip eliminates tangled ropes
- Limited Warranty

CUTS UP TO  $1\frac{1}{4}$  IN

# MAX ACCESSORIES



## MAX | LEATHER SCABBARD

**AC 7220 | 5 IN**

- Universal design fits most hand pruners and folding saws up to 8 in
- Top-grain leather construction
- Stitched and riveted for durability
- Belt clip and loops included
- Pouch depth: 5 in
- Limited Lifetime Warranty



## UNIVERSAL TOOL POUCH

**AC 4510 | 5 IN**

- Universal design fits hand pruners and folding saws up to 8 in
- Durable nylon construction
- Easy to carry using metal clip or belt loops
- Front pocket for sharpener storage
- Pouch depth: 5 in
- Limited Warranty



## SHARPENING TOOL

**AC 8300**

- Ideal for sharpening all blades (excludes saw blades)
- Easy to use instructions are on back of the packaging
- 5 in super carbide file
- Easy to fit in pocket
- Non-slip grip for easy use
- Limited Warranty



## MAXFORGED | HEDGE SHEAR

**NEW**

### ClassicCUT

**HS15150** | 10 IN BLADES | 12 1/2 IN STEEL HANDLES

- Enhanced performance with large cuts due to patented blade and hook design - includes limb notch
- Resharpenable, forged alloy steel blades
- Comfortable steel handles with contoured soft grips fits various hand sizes
- Shock-absorbing integrated bumper
- No-fail metal end cap
- Limited Lifetime Warranty
- **REPLACEMENT PARTS AVAILABLE**



## MAXFORGED | HEDGE SHEARS

### SerratedBLADE

**HS 6920** | 8 1/2 IN BLADES | 9 1/2 IN HARDWOOD HANDLES

**HS 6930** | 8 1/2 IN BLADES | 20 IN HARDWOOD HANDLES

- Resharpenable, forged steel alloy blades
- Fully heat-treated for strength
- Serrated top blade and limb notch in lower blade
- Shock Stop® bumper
- Bolted-on hardwood handles with non-slip grips
- Limited Lifetime Warranty
- **REPLACEMENT PARTS AVAILABLE**



## MAXFORGED | HEDGE SHEARS

### SerratedBLADE

**AH 6940** | 8 1/2 IN BLADES | 13 IN ALUMINUM HANDLES

**AH 6950** | 8 1/2 IN BLADES | 21 IN ALUMINUM HANDLES

- Resharpenable, forged steel alloy blades
- Fully heat-treated for strength
- Serrated top blade and limb notch in lower blade
- Dual forged-in bumper cups with elastomer bumpers
- Lightweight, high-strength elliptical aluminum handles
- Limited Lifetime Warranty
- **REPLACEMENT PARTS AVAILABLE**



## MAXFORGED | HEDGE SHEARS

### ResharpenableBLADE

**HS 6960** | 10 IN BLADES | 9 1/4 IN HARDWOOD HANDLES

- Resharpenable, forged steel alloy blades
- Fully heat-treated for strength
- Limb notch
- Shock Stop® bumper
- Bolted-on hardwood handles, comfortable non-slip grips
- Limited Lifetime Warranty
- **REPLACEMENT PARTS AVAILABLE**



## MAXFORGED | HEDGE SHEARS

### LimbNOTCH Blade

**AH 6970** | 10 1/2 IN BLADES | 12 1/2 IN ALUMINUM HANDLES

- Resharpenable, forged steel alloy blades
- Fully heat-treated for strength
- Limb notch in lower blade
- Dual forged-in bumper cups with elastomer bumpers
- Lightweight, high-strength elliptical aluminum handles
- Limited Lifetime Warranty
- **REPLACEMENT PARTS AVAILABLE**



## MAXFORGED | HEDGE SHEARS

### ExtendableREACH

**HS 3950** | 10 IN BLADES | 13 IN - 20 IN STEEL HANDLES

- Lightweight steel handles with comfort grips extend from 13 in to 20 in
- Forged, high-carbon steel blades for durability and strength
- Precision-made pivot bolt provides smooth cutting action
- Shock Stop® bumper reduces arm and shoulder fatigue
- Limited Lifetime Warranty



## MAXFORGED | HEDGE SHEAR

### DualCUT

**HS 7140** | 10 IN BLADES | 12 1/2 IN STEEL HANDLES

- Enhanced performance with large cuts due to patented design - includes limb notch
- Easy to sharpen
- Comfortable steel handles with contoured soft grips fits various hand sizes
- Shock-absorbing integrated bumper
- No-fail metal end cap
- Limited Lifetime Warranty
- **REPLACEMENT PARTS AVAILABLE**

Patents U.S. D664,406, 8,910,386, Canada 2,775,512

# HEDGE SHEARS

## DualLINK™

Boosted power and reduced effort unite through **DualLINK™** tools, that utilize a dual compound lever designed for both engaged gardeners and landscapers searching for ease-of-cut.

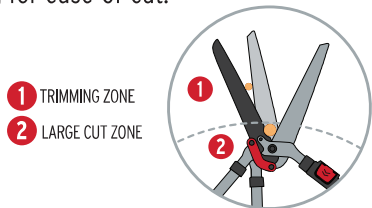

### HEDGE SHEAR

#### DualLINK™

with **ComfortGEL®** grip

**HS 4244 | 9 3/4 IN BLADES | 14 IN HANDLES**

- Minimize cutting effort with DualLINK linkage - open handles less to cut more
- Steel handle
- Less fatigue with ShockGUARD® bumper system
- Limited Warranty

U.S. Patent D703,498



### EXTENDABLE HEDGE SHEAR

#### DualLINK™

with **ComfortGEL®** grip

**HS 4344 | 9 3/4 IN BLADES | 16 3/4 IN - 24 5/8 IN HANDLES**

- Minimize cutting effort with DualLINK linkage - open handles less to cut more
- Less fatigue with ShockGUARD® bumper system
- Aluminum outer handle, steel inner handle
- ComfortGEL® Hedge Shear
- Extendable handles with innovative locking mechanism
- Limited Warranty

U.S. Patent D703,498 and D712,230



### EXTENDABLE HEDGE SHEAR

**NEW**

#### ComfortGEL®

**HS 3344 | 9 IN BLADES | 16 3/4 IN - 24 5/8 IN HANDLES**

- Extendable handles with innovative locking mechanism
- Lightweight steel handles with ComfortGEL® grips
- Specially coated non-stick blades provide maximum cutting performance
- Reduced hand and shoulder fatigue with Shock Guard® bumper system
- Limited Warranty



### HEDGE SHEAR

#### ComfortGEL®

**HS 3244 | 9 IN BLADES | 13 IN HANDLES**

- Lightweight steel handles with comfort grip
- Specially coated non-stick blades provide maximum cutting
- Reduced hand fatigue with ShockGUARD® bumper system
- Maximize comfort and control with soft, ergonomically shaped grips
- Limited Warranty



### HEDGE SHEAR

**HS 3911 | 8 1/2 IN BLADES | 9 1/2 IN HARDWOOD HANDLES**

- Resharpenable steel alloy blades
- Fully heat-treated for strength
- Limb notch for larger branches
- Top-grade hardwood handles
- Comfortable non-slip grips
- Limited Warranty
- **REPLACEMENT PARTS AVAILABLE**

### VALUE HEDGE SHEAR

All Value Tools carry a 1-year limited warranty

### HEDGE SHEARS

**AH 4220 | COMPOUND ACTION | 9 IN BLADES | 11 1/2 IN HANDLES**

- Compound cutting action
- Steel blades - one serrated, one non-stick coated
- Aluminum handles with plastic grip

# MAX GRASS SHEARS

STRENGTH & DURABILITY™



### MAXFORGED | GRASS SHEAR

#### ClassicCUT®

**GS 6750D**

- Cuts tough sod and ground cover
- Professional cutting action
- Resharpenable, forged steel alloy blades
- Fully heat-treated for strength
- Comfortable, non-slip grip
- Limited Lifetime Warranty
- **REPLACEMENT PARTS AVAILABLE**



### PUMP-ACTION GRASS SHEAR

**GS 3760**

- Hard, chrome-plated, high-carbon steel blades are fully heat-treated
- Adjustable tension control for maximum shearing
- Steel body construction
- Foam grip for comfortable use
- Limited Warranty



### SWIVEL GRASS SHEAR

**GS 3750D**

- Versatile three-position blade - vertical for edging, horizontal for trimming, angled for hard-to-reach areas
- Precision-ground, high-carbon steel blades
- Durable chrome plating
- Easy-to-set thumb lock
- Limited Warranty

# GRASS SHEARS