

Happy D.2 Furniture washbasin # 2318800000 / 2318800030

|< 31 1/2" Inch >|

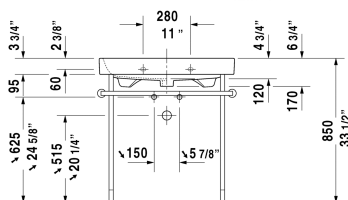
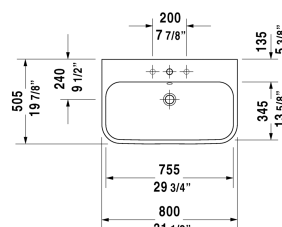
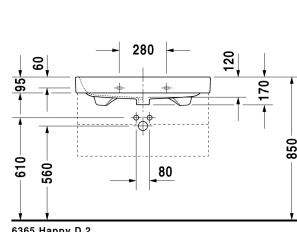

Furniture washbasin	Dimension	Weight	Order number
with overflow, with tap platform, overflow clip Chrome included, hardware included, wall-mounted, 31 1/2" Inch			
Colors			
00 White			
Variant			
●	31 1/2" x 19 7/8" Inch	57.1 lb	2318800000
● ● ●	31 1/2" x 19 7/8" Inch	57.1 lb	2318800030
Sanitary ceramics with the special WonderGliss surface finish will remain clean and attractive-looking for a long time to come. When ordering WonderGliss please add a "1" as eleventh digit to the model number.			
Space-saving siphon	1 1/4" Inch	0.9 lb	005076
Suitable products			
Vanity unit wall-mounted 2 drawers, upper drawer including cut-out for siphon and siphon cover, for Happy D.2 # 231880 (not ground), 30 1/2" x 18 7/8" Inch	30 1/2" x 18 7/8" Inch		H26365
Metal console height adjustable +2", Chrome, for washbasin # 231880, 26 1/8" x 19 1/4" Inch	26 1/8" x 19 1/4" Inch		003077
Vanity unit floorstanding 2 drawers, upper drawer including cut-out for siphon and siphon cover, for Happy D.2 # 231880 (not ground), 30 1/2" x 18 7/8" Inch	30 1/2" x 18 7/8" Inch		H26373

All drawings contain the necessary measurements which are subject to standard tolerances. They are stated in inch & mm and are non-binding. Exact measurements, in particular for customized installation scenarios, can only be taken from the finished ceramic piece.

Happy D.2 Furniture washbasin ground # 2318800025 / 2318800027

|< 31 1/2" Inch >|

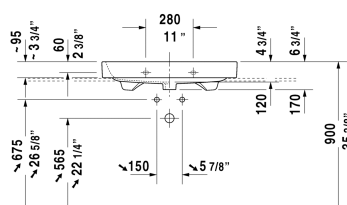
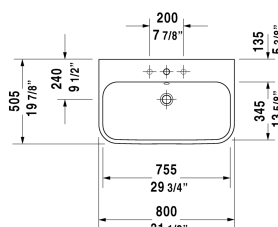

Furniture washbasin ground	Dimension	Weight	Order number
with overflow, with tap platform, overflow clip Chrome included, hardware included, wall-mounted, 31 1/2" Inch			
Colors			
00 White			
Variant			
● ● ●	31 1/2" x 19 7/8" Inch	57.1 lb	2318800025
●	31 1/2" x 19 7/8" Inch	57.1 lb	2318800027
Sanitary ceramics with the special WonderGliss surface finish will remain clean and attractive-looking for a long time to come. When ordering WonderGliss please add a "1" as eleventh digit to the model number.			
Suitable products			
Vanity unit for console 1 pull-out compartment, compartment consists of glass dividers and 2 boxes (small/large), 31 1/2" x 21 1/2" x 21 1/2" Inch			XL6713
Vanity unit for console 1 pull-out compartment, compartment consists of glass dividers and 2 boxes (small/large), 39 3/8" x 21 1/2" Inch	39 3/8" x 21 1/2" Inch		XL6715
Vanity unit for console 2 drawers, upper drawer including cut-out for siphon and siphon cover, 39 3/8" x 21 1/2" Inch	39 3/8" x 21 1/2" Inch		XL6716
Vanity unit for console 2 drawers, upper drawer including cut-out for siphon and siphon cover, 39 3/8" x 21 5/8" Inch	39 3/8" x 21 5/8" Inch		H26302
Vanity unit for console 1 pull-out compartment, 40 1/8" x 21 1/2" Inch	40 1/8" x 21 1/2" Inch		LC6829
Vanity unit for console with 2 drawers, upper drawer including cut-out for siphon and siphon cover, 40 1/8" x 21 1/2" Inch	40 1/8" x 21 1/2" Inch		LC6839
Console for above-counter basin and vanity basin 1 console with one cut-out, Width min. see ordering information, Width max. 78 3/4", price per section of 3 7/8", basic price until 31 1/2", 21 5/8" Inch	21 5/8" Inch		LC096C

Happy D.2 Furniture washbasin ground # 2318800025 /
2318800027

|< 31 1/2" Inch >|

Console for above-counter basin and vanity basin 1 console with
two cut-outs, Width min. see ordering information, Width max.
78 3/4", price per section of 3 7/8", basic price until 31 1/2", 21
5/8" Inch

LC097C

All drawings contain the necessary measurements which are subject to standard tolerances. They are stated in inch & mm and are non-binding. Exact measurements, in particular for customized installation scenarios, can only be taken from the finished ceramic piece.